

**TRIUMPH  
TIGER 90**

**1937  
MODELS**

1929 CN, 550cc, CSD, 500cc, Ex Pipe  
A593 Unchromed EURO 60.00.

2H: 3S: 3SE: 3H: 5H: 6S:  
TIGER 70: TIGER 80; TIGER 90

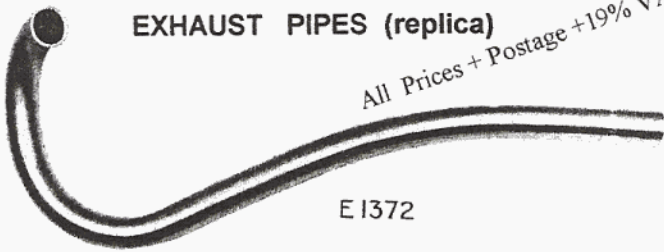

**EXHAUST PIPES (replica)**

All Prices + Postage + 19% VAT. Alle Preise + Versand Gelten ZZGL MWS 19%.

E 1372

T.90 Ex pipe (High Level) E1372  
Unchromed EURO 59.00.

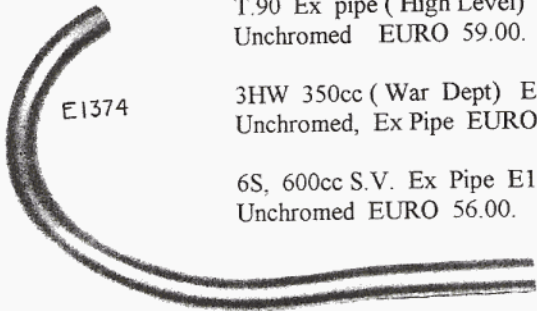

E 1374

3HW 350cc (War Dept) E1380  
Unchromed, Ex Pipe EURO 56.00

6S, 600cc S.V. Ex Pipe E1374  
Unchromed EURO 56.00.



**CRANKSHAFT BEARING**

T.90, 5H, 6S, NEW Big End Bearing (Complete)  
E513 EURO 263.00.

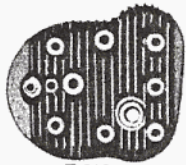

E 619  
E 1297

6S, C. Head (Genuine Triumph) NEW,  
E.1297 EURO 62.00.

**BATTERY CARRIER**

Triumph Rigid 3T, 5T, 6T, Battery Carrier (Replica)  
Also fits pre war models. EURO 44.00.

Pre War Battery Carrier (STRAPS) With Trunnions.  
Stainless Steel, Top EURO 14.00. Front EURO 18.60

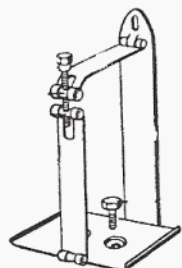

Magdyno Straps (Stainless Steel) Front E.530. Rear E.531.  
(Includes E.535 and E534 Trunnions) Rear, EURO 22.00  
Front, EURO 19.00. (Fits all Models)

Magdyno Mag Strap Connecting Bolt E.536. Washer E.538  
+ Nut (Fits all Models) EURO 7.50

# TRIUMPH

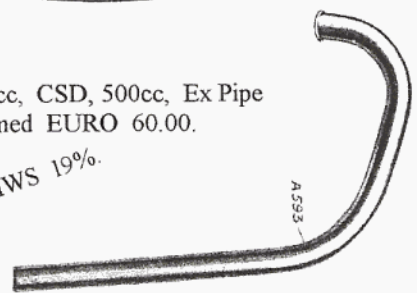

**TRIUMPH 6S**

Triumph 6S Always A Large Stock Of  
Used Engine Parts, C.Heads, Cylinders. Cams,  
Con Rods, Crankshafts, ETC

**GASKETS**

Sump Gaskets (Genuine Triumph) TWO E..487.  
(Fits all Models) EURO 3.20

Oil Feed Pipe Gasket E.527 (Genuine Triumph) EURO 1.60

Oil Pump T.Cover Gasket E.490. (Genuine Triumph) EURO 4.70

Magneto To Crankcase Cork Seal (Genuine Triumph) EURO 6.00



E 490



E 487



E 527

Oil Pump Alloy Block E.495. (Fits all Models) EURO 10.00



E 495

**GEARBOX SPROCKET**

T90, 5H, 6S. Gearbox Sprocket 18T.  
T471 3/8 X 5/8. (For Machines Built After 1937)  
EURO 25.00



T439  
T471

Timing Cover Plug (Genuine Triumph) E732.  
(Fits all Models) EURO 10.00.



E 732

Crankshaft Timing Pinion E.498 (New Genuine Triumph)  
EURO 39.00 (Some used in stock)

**CORNUCOPIA  
ENTERPRISES**



E 498

**MAGNETO STRAPS**

E 534



E 531

E 535



E 530

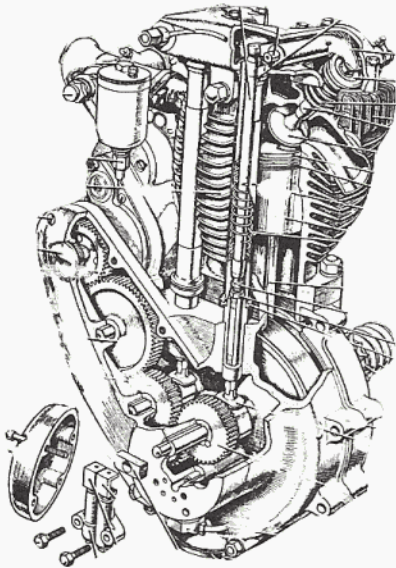

# TRIUMPH

## MOTOR CYCLE

CORNUCOPIA   
ENTERPRISES

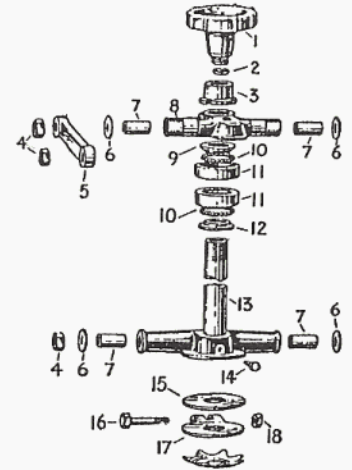

### TRIUMPH PRE WAR STEERING HEAD BEARINGS (REPLICA)

TO FIT 1934/5/6 MODELS 3/2. 3/5. 5/1. 5/2. 5/3. 5/4. 5/5. 2/1. 2/5. 3/1. L2/1. TIGER 70/ 80/ 90. SET BEARINGS EURO 130.20. SET STEEL BALL BEARINGS (TOP 24. 3/16. S704) ( BOTTOM 20 1/4 S703) SET EURO 6.90.



TO FIT 1937-1940 SINGLES and TWINS. 250cc ,350cc MODELS 1937-41. 3HW 350cc WAR DEPT MODELS 1941-45. SINGLES 2/H. 3/S. 3/SE. 3/H. T 70. T80. 5/S. 5SE.

FRAME CUP BEARING ( TOP and BOTTOM) XS10 (TWO NEEDED) EACH EURO 34.10. STEERING YOLK TOP CONE XS9 EURO 31.00. BOTTOM YOLK CONE XS8 EURO 31.00. SET EURO 130.20. STEERING RACE BALL BEARINGS (TOP 24. 3/16. S704) (BOTTOM 22.3/16 S703) SET EURO 6.90.



FOR 1934/5/6 MODELS BOTTOM FRAME CUP BEARING PS8C EURO 34.10.

TO FIT 1937-40 SINGLES and TWINS. 3T TWIN FRAME CUP BEARINGS. 5/H. 6/S. 5T. T.100.



FRAME CUP BEARING BOTTOM, H.111 EURO 34.10 TOP FRAME CUP PS9A EURO 34.10 STEERING YOLK TOP CONE PS8A 34.10 STEERING YOLK BOTTOM CONE PS7B 34.10 SET EURO 136.40

STEERING RACE, BALL BEARINGS (TOP 24. 3/16.) (BOTTOM 20 1/4) EURO 6.90 SET



## Side Lifting Handel

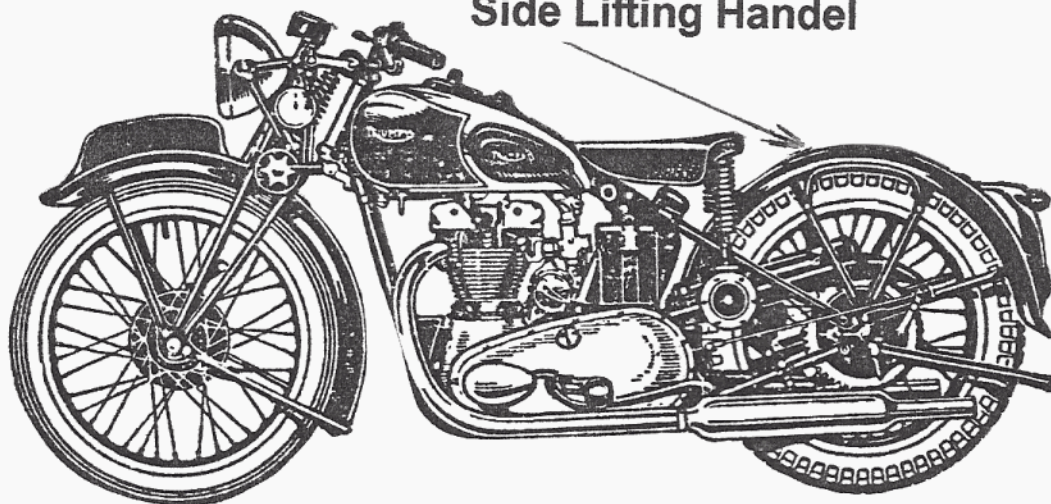

# TRIUMPH

## MOTOR CYCLES

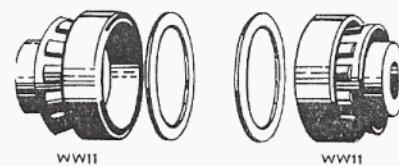

Replica 1930s TRIUMPH Rear Mudguard Side Lifting Handel (two Needed Left and right) Part no NF733 Previous no,A1288C Fits all singles, and twins, EURO 60.00 Pair.

CORNUCOPIA   
ENTERPRISES

Genuine TIMKIN ROLLER Front Wheel Bearings (for girder fork models ) EURO 95.00 EACH

### TRIUMPH VALVES.

- 1935/36 250cc o.h.v L.2/1 (Single Port) Inlet.
  - 1936/40 250cc o.h.v T.70/ 21/2h/ 2hc. Inlet.
  - 1937/9 350cc S.V. 3/1/3S/3SE. Single Inlet+ Exhaust.
  - 1936/40 350cc o.h.v 3/2. 3h. T.80. Inlet + Exhaust.
  - 1940/45 350cc o.h.v Single (War Department) Inlet+ Exhaust.
  - 1940/51 350cc Twin 3T. Inlet + Exhaust.
  - 1938/40 500cc Twin 5T/T100. Inlet + Exhaust.
  - 1940/51 500cc Twin 5T/ T100 Inlet + Exhaust.
  - 1946/59 500cc Twin 5T/T100 Inlet +Exhaust.
  - 1931/32 500cc Single N.T./ C.D. Inlet +Exhaust.
  - 1934/36 650cc Twin 6/1 Exhaust.
  - 1936. T.90 500cc Single. Inlet.
  - 1934/36 493cc Single. T 90. 5/2 /4/5 5/5. Inlet + Exhaust.
  - 1937/40 500cc Single o.h.v T90. 5H. Inlet + Exhaust.
  - 1950/60 500cc Twin S.V. TRW Inlet + Exhaust.
- Valves Each EURO 25.00 To 31.00 + V.A.T. 19%

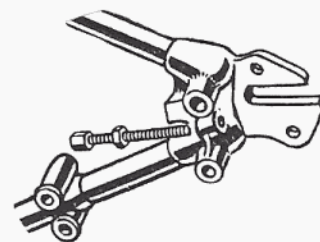

Triumph Rear wheel Adjuster Bolts, with Nut, (Nickle Plated)  
Part No. F.969, F1008.  
Fits all singles + twins  
1937/52 EURO 11.00 Each